

Enware Wellbeing™ 220mm Mixer Spout suits all mixers

The Wellbeing™ tapware range brings Enware's years of experience in producing lever tapware to modern tapware design, addressing the timeless requirements for ease of use, purpose, longevity and up-to-date aesthetic appeal.

Oversize tubular spouts have been designed to ensure a minimum of splashing with laminar flow outlets and flows regulated to ensure water efficiency.

Optimised spout lengths to avoid water flowing directly into waste to prevent aeration of bacteria.* All spouts are supplied with a swivel fixing hex insert and are available with 5 or 6 Star WELS rating.

FEATURES

- Oversize tubular design with concealed aerator
- Long reach spout to avoid waste outlet
- Long reach spout capable of being fixed or swivel
- Water efficient laminar flow outlets for 5 Star WELS Requirements
- 5 Year Commercial Warranty

OPTIONS

- 5 and 6 star WELS Rating

WBMIX220



Product Code

WBMIX220-5 220mm Mixer Spout 5 Star WELS

WBMIX220-6 220mm Mixer Spout 6 Star WELS



AS/NZS 3718 WMKA 1583
SAI Global



Technical Information

Working Pressure Range	50-800kPa
Recommended Maximum Pressure	500kPa **
Maximum Working Temperature*	5°C - 85°C **

**Enware products are to be installed in accordance with the Plumbing Code of Australia and AS/NZS3500.

Thermostatic mixing valves may be required.

Reference should also be made to the Australasian Health facility Guidelines (AusHFG), ABCB Regulations and Local Building Codes when considering the choice of, and the installation of these products.

NOTE: Enware Australia advises:

1. Due to ongoing Research and Development, specifications may change without notice.
2. Component specifications may change on some export models.
3. Refer to Warranty Statement for Warranty details www.enware.com.au/warranty

*Optimised with Enware IFO basins

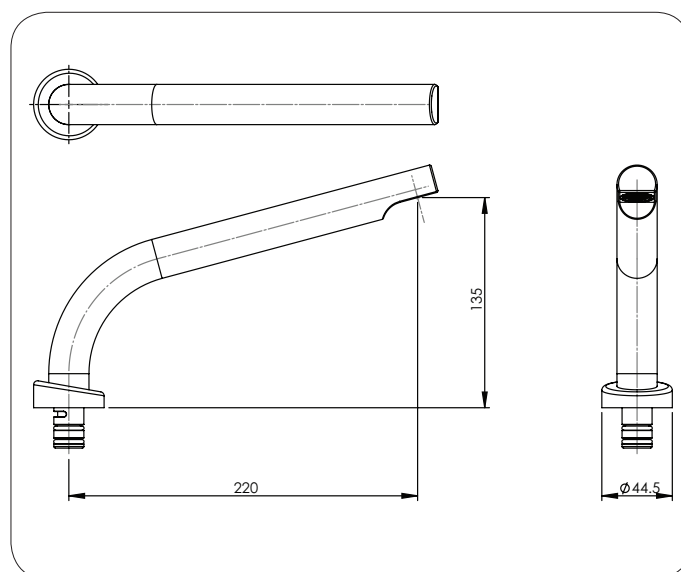

Version: Feb 17

Call 1300 369 273
www.enware.com.au

Enware Australia Pty Limited
9 Endeavour Rd Caringbah NSW 2229 Australia
Ph: 02 8536 4000 Fax: 02 8556 4055

 **ENWARE**
installing**confidence**