

# Enware Wellbeing™ Ceramic Disc Basin Set 65mm Lever with 165mm spout

## WBBCD65-165

The Wellbeing™ tapware range brings Enware's years of experience in producing lever tapware to modern tapware design, addressing the timeless requirements for ease of use, purpose, longevity and up-to-date aesthetic appeal.

Ergonomic lever design allows use with a minimum of effort and manipulation to accurately set desired temperature and flow. A chrome plated base unit combined with a lever crafted from the latest polymers offers warm luxurious tactility, fashionable looks with bright indication.

Optimised spout lengths to avoid water flowing directly into waste to prevent aeration of bacteria.\* All spouts are supplied with a swivel fixing hex insert and are available with 5 or 6 Star WELS rating.

### FEATURES

- Ergonomic anti-bacterial tactile lever
- Smooth low inertia ceramic disc operation
- Colour Indicators for hot/cold/warm
- Long reach spout capable of being fixed or swivel
- Water efficient laminar flow outlets for 5 Star WELS Requirements
- O-ring seals to bench top
- 5 Year Commercial Warranty

### OPTIONS

- 5 Star WELS supplied as standard, 6 star rating available

### Product Code

**WBBCD65-165-5** Basin Set Ceramic Disc 65mm Lever  
165mm Spout 5 Star WELS

**WBBCD65-165-6** Basin Set Ceramic Disc 65mm Lever  
165mm Spout 6 Star WELS



### Technical Information

Working Pressure Range	50-800kPa
Recommended Maximum Pressure	500kPa **
Maximum Working Temperature*	5°C - 85°C **

\*\*Enware products are to be installed in accordance with the Plumbing Code of Australia and AS/NZS3500.

Thermostatic mixing valves may be required.

Reference should also be made to the Australasian Health facility Guidelines (AusHFG), ABCB Regulations and Local Building Codes when considering the choice of, and the installation of these products.

NOTE: Enware Australia advises:

1. Due to ongoing Research and Development, specifications may change without notice.
2. Component specifications may change on some export models.
3. Refer to Warranty Statement for Warranty details [www.enware.com.au/warranty](http://www.enware.com.au/warranty)

\*Optimised with Enware IFO basins

Due to handles being spline mounted, handles may be offset slightly from vertical or straight. This is normal and unavoidable

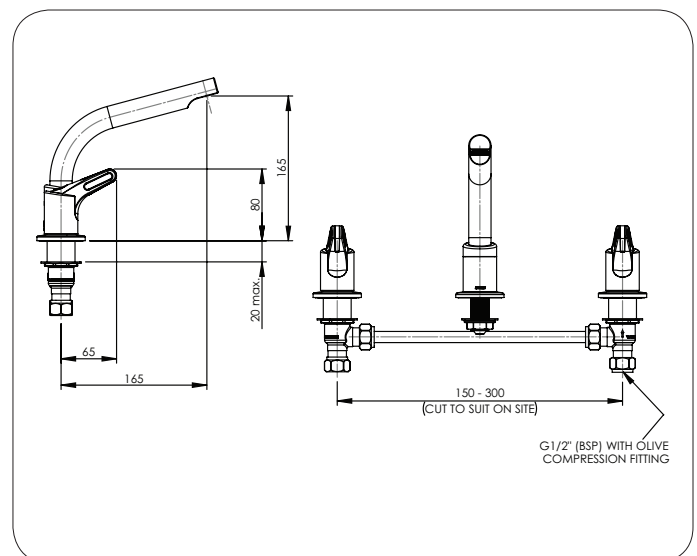

Version: Aug 18

**Call 1300 369 273**

**[www.enware.com.au](http://www.enware.com.au)**

Enware Australia Pty Limited  
9 Endeavour Rd Caringbah NSW 2229 Australia  
Ph: 02 8536 4000 [info@enware.com.au](mailto:info@enware.com.au)

