

Key Operated Hose Tap MI 20mm Brass - Jumper Valve - With Key Handle

VPK351

Provides control over water systems exposed to the public by using a removable key when isolating or adjusting the valve. The key operated vandal resistant range is made from dezincification resistant (DR) brass.

KEY FEATURES

- Removable key protects against unauthorised use and water wastage
- Jumper valve
- Includes key handle (rough brass finish)
- 3/4" BSP male inlet, 1" BSP outlet connection
- High quality construction with rough brass finish
- Serviceable with all wearing components replaceable, thus providing an even longer life

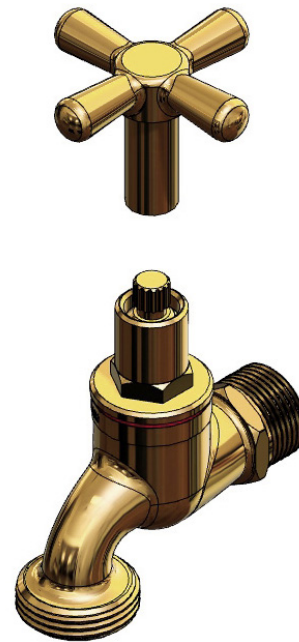

PRODUCT CODES

VPK351	Key Operated Hose Tap MI 20mm Brass - Jumper Valve - With Key Handle
RB356	Key Handle Only (Rough Brass Finish) for Key Operated Hose Tap

Key Operated Hose Tap MI 20mm Brass - Jumper Valve - With Key Handle

TECHNICAL INFORMATION

Maximum Static Pressure	1200kPa
Working Pressure Range	30-500kPa
Maximum Working Temperature	95 °C (Jumper Valve)

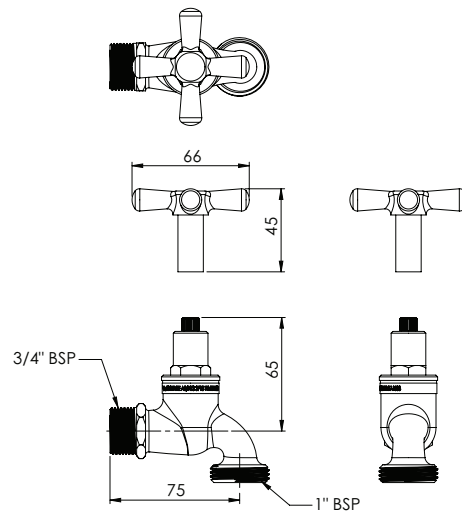

Enware products are to be installed in accordance with the Plumbing Code of Australia and AS/NZS3500. Reference should also be made to the Australasian Health facility Guidelines (AHFG), ABCB and Local Government regulations when considering the choice of, and the installation of these products.

Enware Australia advises:

1. Due to ongoing Research and Development, specifications may change without notice. 2. Component specifications may change on some export models. 3. Refer to warranty statement for warranty details - www.enware.com.au/warranty

Version 1.0__23Jun22