

ENWARE - SYDNEY WATER

MLIM Installation Guide

Installation & Maintenance Instructions

HYDRUS DN20

Ultrasonic Cold Water Meter with Installation Bracket

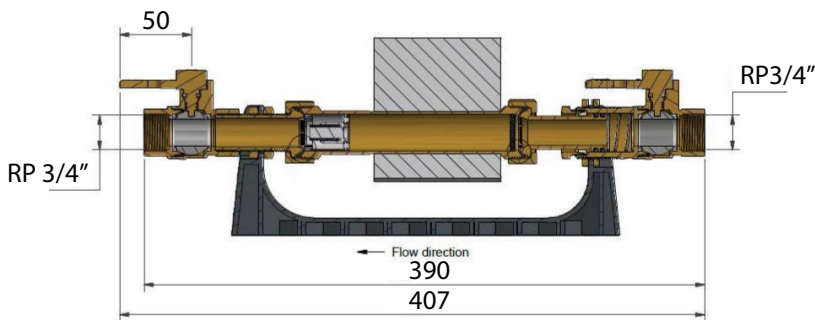

Product Code EHM5020SW-B

Note: installation brackets are only available for DN20 meters

HYDRUS DN20

Ultrasonic Cold Water Meter with Ball Joint Couplings

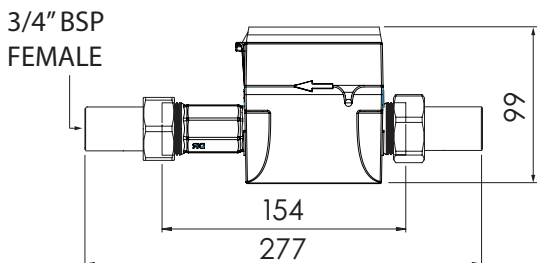

Product Code EHM5020SW

HYDRUS DN25

Ultrasonic Cold Water Meter with Ball Joint Couplings

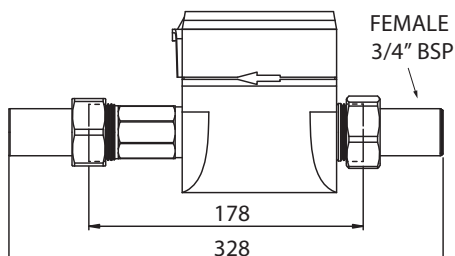

Product Code EHM5025SW

Installation Instructions

- All DN20 & DN25 individual meters have integrated Dual Check Valves (DCV). These must not be removed.
- The individual meter must be installed in a common area to ensure unrestricted access.
- Meters must not be installed in individual units. Meters must not be installed under kitchen sinks, laundry tubs or in ceiling cavities.
- The area where meters are installed shall be designed to allow for drips and small leaks when meters are replaced.
- It is recommended that meter be installed in a non-metallic enclosure or cupboard. This could also be a dedicated hydraulic plant room or meter utility room with appropriate access.
- If meters are installed in a cupboard/room, the cupboard/rooms must be clearly labelled "Water Meters".
- It is recommended that each meter is placed on the same floor as the unit. However in smaller buildings meters may be grouped together on the ground floor or alternate floors.
- The meter may be installed in the basement (only one level below street level) however consideration should be given to future access needs for meter maintenance.
- Meters can be installed horizontally or vertically.

METERING CUPBOARD INFORMATION

Meter Clearances should be:

- No less than 150mm above finished floor level.
- No greater than 1.5m above finished floor level.
- With a minimum clearance of 150mm for DN20 and 200mm for DN25 between the centre of each pipe and any wall or door.

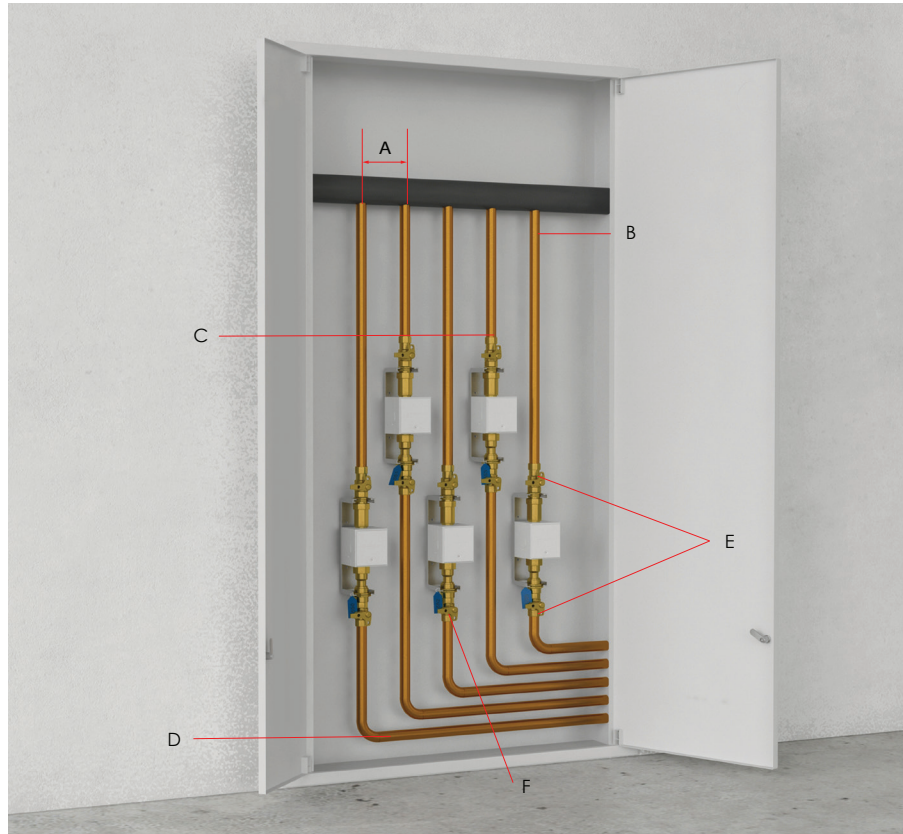

Index

A	DN20: 150mm between the centre of each pipe
	DN25: 200mm between the centre of each pipe
B	150mm from pipe centre to cabinet wall
C	No higher than 1.5m from the ground
D	No lower than 150mm from the ground
E	1/4 turn Isolation valve before and after all water meters
F	<p>A permanent waterproof identification label must be fitted to the fixed pipe on the outlet side of the individual meter. Metal tags with stamped details or a key ring with permanent marker are recommended.</p> <div style="text-align: center;"> <p>50mm</p> <p>25mm</p> <p>Unit #: 123</p> <p>Hole to allow attachment to meter assembly</p> </div>

INSTALLATION INSTRUCTIONS

RDC Installation Requirements

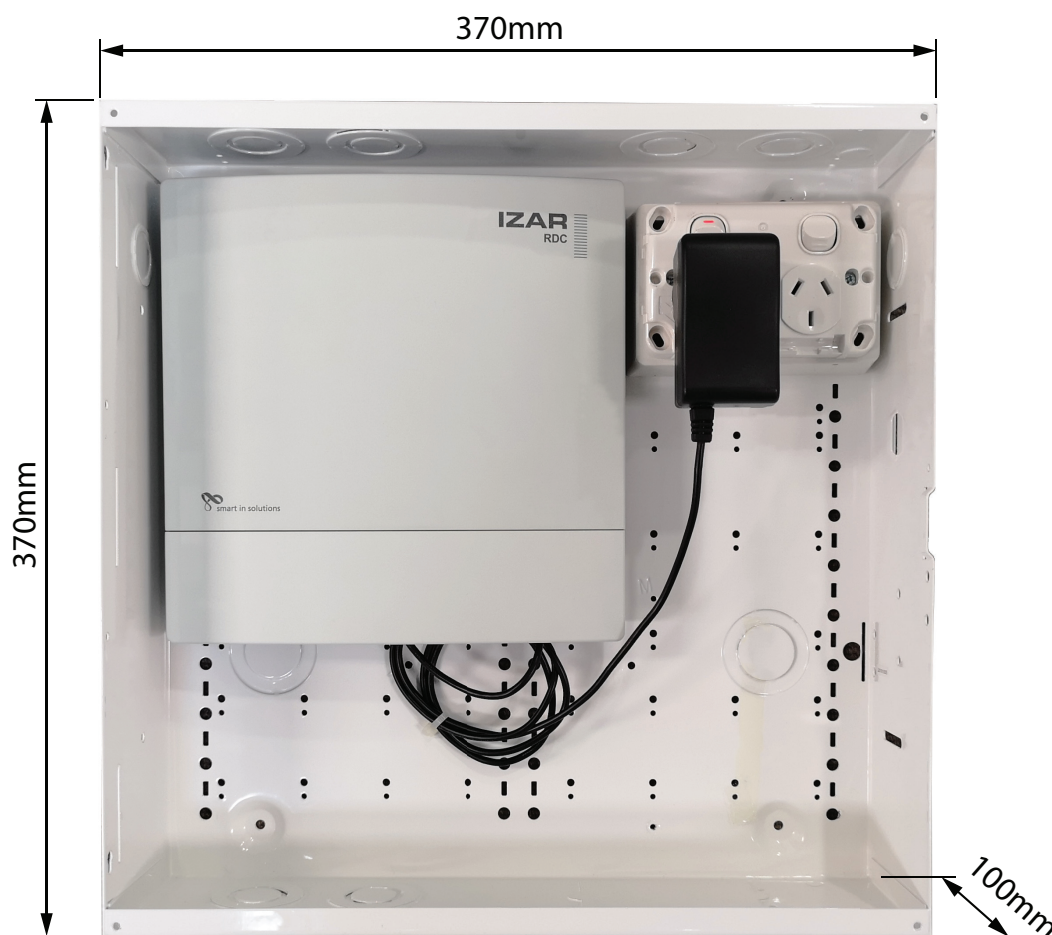

- A dedicated 240V 10A point is required per RDC.
- Ensure there is enough room around the power point for the logger box to be installed.
- RDCs are to be installed in the Communications or Electrical room.
- RDCs can be installed in the Meter Cupboard **ONLY WHERE GAS METERS ARE NOT PRESENT.**
- RDC locations are different per project and consultation with the Enware team is recommended at the early stages of your project.
- The RDC is supplied with up to 2 antennas for receiving meter information. Please see back page for more information on antennas.

EXTRA INFORMATION

434 MHZ Receiving Antenna

- Antennas are supplied with a cable length of 5M (RG58C/U) to be installed in multiple positions to best suit your project. Examples of antenna locations include the rooftop, or up to 2 floors above/below the location of the RDC.
- Antenna used for receiving meter telegrams and not used for any data transmission.
- MBC Mounting Base (included)
- Antenna type used on site is subject to change depending on the installation requirements.

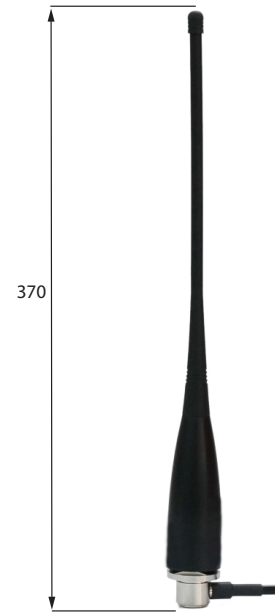

Master Meter

- The total cold water supply to the building must be metered through a master meter.
- The Master Meter is supplied by Sydney Water through the normal meter application channel process (e.g. Quick Check, web etc).
- Master Meters must be installed prior to booking commissioning. Enware will require photos of the master meter prior to commissioning to ensure the correct equipment is purchased to connect into the Sydney Water System.



ADDRESS: 9 Endeavour Road, Caringbah NSW 2229 Australia

POSTAL ADDRESS: P.O. Box 2545, Taren Point NSW 2229 Australia

PHONE: 61 2 8536 4000

1300 369 273 [AUS] WWW.ENWARE.COM.AU INFO@ENWARE.COM.AU