

# Restore Mental Health Wall Mixer - Front-of-Wall Assembly

Enware's Restore MH range of Mental Health Secure Ensuite basin and shower mixers help to normalise the bathroom environment while providing safe, secure and comforting experiences.

Supplied as Front-of-Wall and Back-of-Wall Assemblies.

## KEY FEATURES

- Normalized shower mixer design to assist rehabilitation with easy to clean bright chrome finish
- Patient safety at the heart of the design with anti-ligature handle tested to TS001:2013 (Grade A4)
- Robust design for challenging environments with IK10 impact tested front of wall construction
- Low profile ergonomic handle for easy temperature adjustment and water control
- Designed to promote good water health with sequential style mixing always closing through the cold position
- New Lead-Free Brass Mixer is easy to install in its in-wall installation box with variable depth adjustment
- Front of wall surround can be permanently fixed and sealed to wall. Access for maintenance is made through secure removeable fascia, avoiding wall damage or breaching of wall seal
- Supplied as Front of Wall (FOW) and Back of Wall (BOW) assemblies for easy installation



## PRODUCT CODE

RHMIXSQ-FOW	Restore Mental Health Wall Mixer - Front-of-Wall Assembly
-------------	---

Products are to be installed in accordance with the Plumbing Code of Australia and AS/NZS3500.

Reference should also be made to the Australasian Health Facility Guidelines (AHFG), ABCB and Local Government regulations when considering the choice of, and the installation of these products.

Due to ongoing Research and Development, specifications may change without notice.

Component specifications may change on some export models.

Refer to warranty statement for warranty details - [www.enware.com.au/warranty](http://www.enware.com.au/warranty).

# Restore Mental Health Wall Mixer - Front-of-Wall Assembly

## TECHNICAL DATA

Finish	Chrome
Facia Plate Material Grade	Stainless Steel
Technical Notes	Requires Back-of-Wall Component RHMIXSQ-BOW

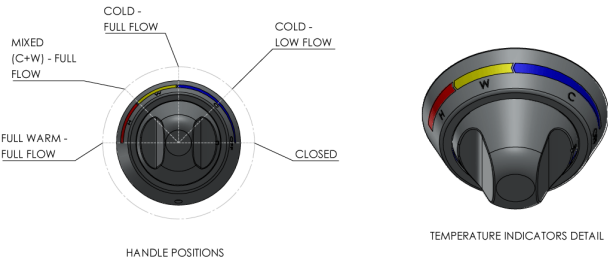
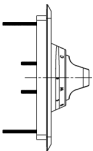
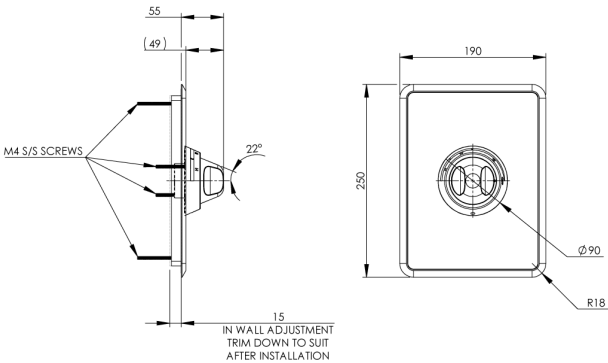

## REQUIRED OPTIONS

RHMIXSQ-BOW	Restore Mental Health Wall Mixer - Back-of-Wall Assembly
-------------	--