

Leva Type 56 150mm Wall Mounted Mixing Set with Fixed Spout

The Leva range combines outstanding quality with functional, beautiful design. Ideal for Hospital and Aged Care applications, providing the benefits of easier reach and control. The 150mm lever allows hands-free elbow operation. Tap is designed to reduce bacterial capture points, and make cleaning easier. This product is suitable to be used in a Type A or Type B clinical hand wash application. Surgeon tapware is suitable as a surgeon set or surgeon mixer.

KEY FEATURES

- 1/4 Turn Ceramic disc
- Ergonomic sleek design 150mm lever handles
- Robust construction for superior performance
- Unique handle fixing is easy to fit, secure and durable
- Concealed pressure compensating flow controlled aerator for a clean look and water efficiency
- Clear identification on all lever handles with blue, yellow or red coloured indicator collars (3 colour indicator collars included)
- Fixed spout with laminar flow - suited to healthcare application
- 5 Star (6Lpm) and 6 Star (4Lpm) laminar flow aerators supplied standard
- Lead free

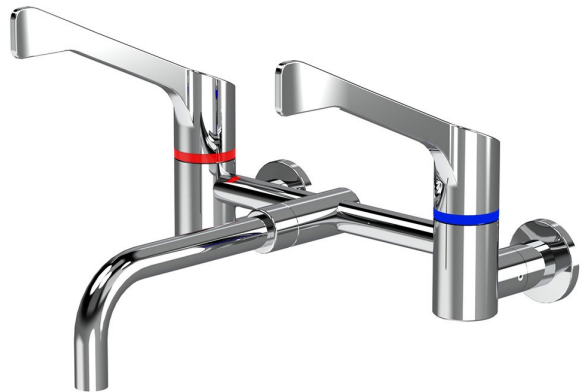

PRODUCT CODE

LEV150420

Leva: Type 56 150mm Wall Mounted Mixing Set with Fixed Spout



Due to ongoing Research and Development, specifications may change without notice. Component specifications may change on some export models.

Refer to warranty statement for warranty details - www.enware.com.au/warranty.

Products are to be installed in accordance with the Plumbing Code of Australia and AS/NZS3500.

Reference should also be made to the Australasian Health Facility Guidelines (AHFG), ABCB and Local Government regulations when considering the choice of, and the installation of these products.

TECHNICAL DATA

| | |
|-------------------------------|----------|
| Finish | Chrome |
| Maximum Operating Temperature | 85°C |
| Minimum Working Pressure | 50kPa |
| Maximum Working Pressure | 500kPa |
| Maximum Static Pressure | 800kPa |
| Inlet Connection | 1/2" BSP |

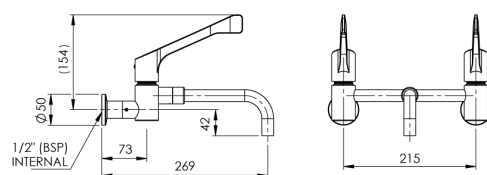
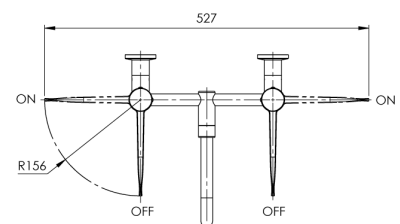

Leva Type 56 150mm Wall Mounted Mixing Set with Fixed Spout

SPARE PARTS

| | |
|------------|--|
| LEV150378 | Spare Parts: Leva - 150mm Lever Handle - Handle Only - Suits Ceramic Disc |
| LEV398 | Spare Parts: Leva Replacement ID Ring Pack |
| WLCS380LTC | Spare Parts: Wellbeing Leva Pil/Bib SBA LTC |
| WLCS380RTC | Spare Parts: Wellbeing Leva Pil/Bib SBA RTC |
| LEVSQHEX | Spare Parts: Leva - Sequential Leva - Hex Spline Adaptor for Basin / Surgeon Mixer |