

Enware Mental Health Kit - 600mm D-Shape Basin, Shroud, Waste and P-Trap

A compact kit offering a contemporary sanitary solution with no ligature points. Suitable for hospitals and aged care facilities.

KEY FEATURES

- No concealment areas-
- No ligature points
- Non-institutional, domestic appearance
- Easy to clean bowl
- AS1428.1 compliant
- Vitreous china basin, fibreglass shroud
- Anti-ligature waste supplied
- Mounting bolts included for wall fixing
- Standard P-trap included



PRODUCT CODE

KOL911600-100MHKIT	Enware Mental Health Kit - 600mm D-Shape Basin, Shroud, Waste and P-Trap
--------------------	--



Due to ongoing Research and Development, specifications may change without notice.

Component specifications may change on some export models.

Refer to warranty statement for warranty details - www.enware.com.au/warranty.

Products are to be installed in accordance with the Plumbing Code of Australia and AS/NZS3500.

Reference should also be made to the Australasian Health Facility Guidelines (AHFG), ABCB and Local Government regulations when considering the choice of, and the installation of these products.

TECHNICAL DATA

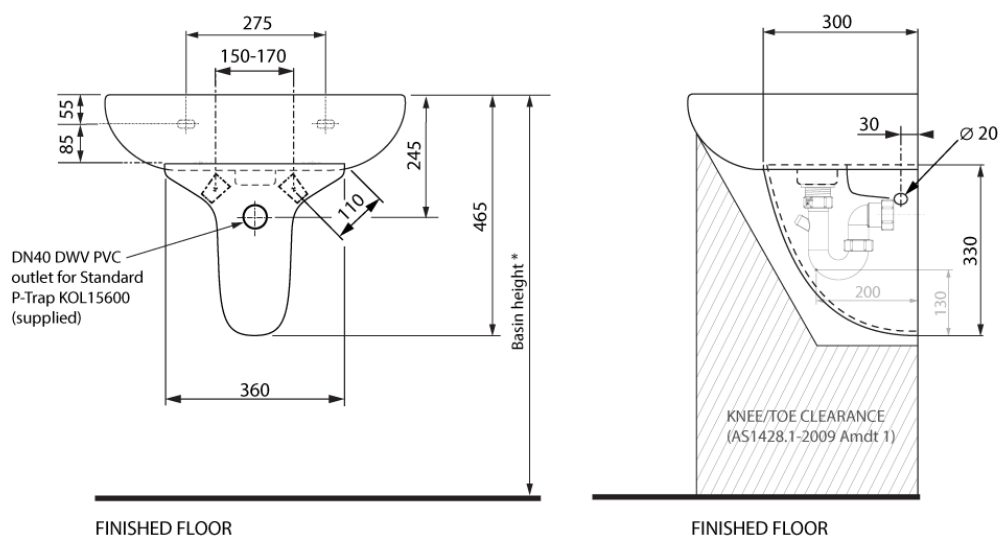

* 850 mm (Recommended) / 865mm (AusHFG) / 800-830mm (AS1428.1)

Enware Mental Health Kit - 600mm D-Shape Basin, Shroud, Waste and P-Trap

SPARE PARTS

IFO3240	Security Waste Chrome 40mm Anti Ligature
IFO4316FK	Spare Parts: Shroud Fixing Kit
IFO707	Spare Parts: Lag Bolts Pack Of 2 Bolts
KOL97200	SHROUD- D-SHAPE 600 BASIN MENTAL HEALTH
KOL15600	Standard P-Trap - 40mm