

Type B Washbasin Kit with Standard Hands-Free Sensor Operated Tap

After comprehensive, laboratory and field testing and feedback from user groups, Enware has produced a functional Type B Handwash Station Kit.

Providing a simple and compliant solution to the requirements of the Australasian Health Facility Guidelines and to meet hospital hand wash guidelines and aid in infection control whilst still being user friendly with easy maintenance.

Ideal for hospitals, health care and research facilities. Kit is made up of Enware D shape basin complete with shroud and Enmatic 5000 series sensor tap.

KEY FEATURES

- Designed in accordance with the Australasian Health Guidelines for Type B wash basin stations
- Spout and waste positions staggered to optimise infection control
- Touch-free sensor tap with wave on/off sensor to prevent cross contamination - 45 secs run time (if not waved off) - ENM5072A-250 with a 230mm spout
- Basin design is anti-waterharbouring with no overflow for better infection control
- Fully rimmed basin for better water and splash retention
- Curved surfaces for better drainage
- Supplied with shroud for superior infection control
- Low maintenance
- Easy access to waste



PRODUCT CODE

KITB02

Type B Washbasin Kit with with Standard Hands-Free Sensor Operated Tap



Due to ongoing Research and Development, specifications may change without notice.

Component specifications may change on some export models.

Refer to warranty statement for warranty details - www.enware.com.au/warranty.

Products are to be installed in accordance with the Plumbing Code of Australia and AS/NZS3500.

Reference should also be made to the Australasian Health Facility Guidelines (AHFG), ABCB and Local Government regulations when considering the choice of, and the installation of these products.

Type B Washbasin Kit with Standard Hands-Free Sensor Operated Tap

TECHNICAL DATA

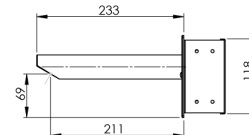
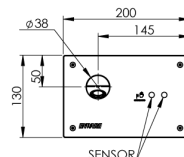
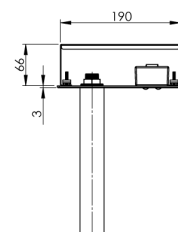
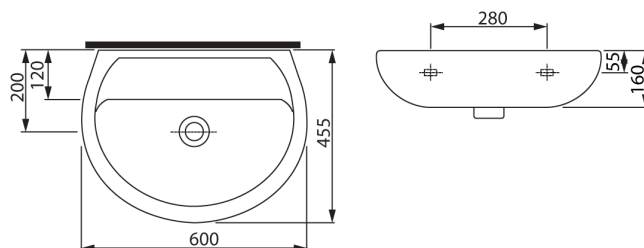
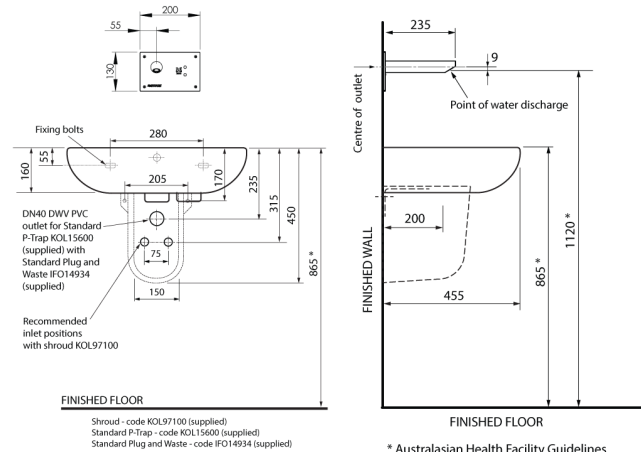

Type B Washbasin Kit with Standard Hands-Free Sensor Operated Tap

SPARE PARTS

ENM5072A-250	Wall Mounted Sensor Tap: Hands-Free On/Off Demand Sensor - 250mm Spout
ENMS133A	Spare Parts: On/Off Demand Sensor, Stainless Plate, Bracket, Transformer and Cables
KOL911600-100	Enware D-Shape Basin 600mm No Tap Hole No Overflow
KOL97101	Shroud for Enware D-Shape 500mm & 600mm Basins
IFO14934	Spare Parts: 40mm Plug & Waste 2-Piece
KOL15600	Standard P-Trap - 40mm
IFO707	Spare Parts: Lag Bolts Pack Of 2 Bolts