

Concealed Spindle Bib Tap FI 50mm Extended with Aerated Outlet - Jumper Valve

CS322F

Concealed spindle tapware series is robust and vandal resistant. The ergonomically designed handle features a dress skirt which conceals the anti-vandal handle fixing and spindle, for aesthetics and easier cleaning. Ideal for commercial, institutional and public amenity applications.

KEY FEATURES

- Jumper Valve
- Fixed spout bib tap
- 3 Star WELS (8 L/min) aerator supplied standard. 5 Star WELS (6 L/min) aerator available on request - specify when ordering
- Vandal-resistant internal locking ring secures the handle which requires special key to release (key supplied)
- Blue (Cold) indicator button supplied standard. Yellow (Warm) and Red (Hot) available on request - specify when ordering.
- Serviceable with all wearing components replaceable, thus providing an even longer life
- Constructed from dezincification resistant (DR) brass
- Durable bright chrome finish

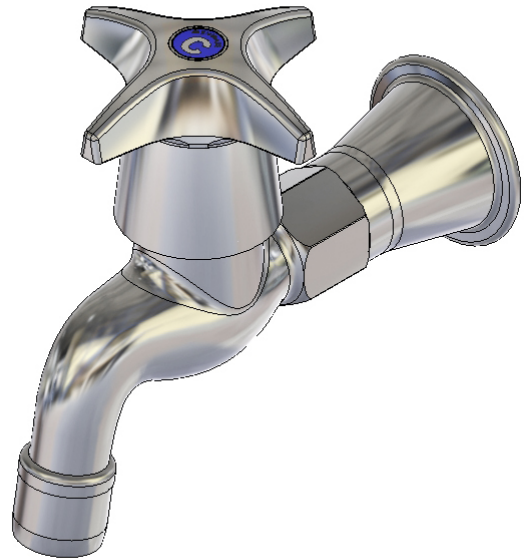

PRODUCT CODES

CS322F	Concealed Spindle Bib Tap FI 50mm Extended with Aerated Outlet - Jumper Valve
--------	---

Concealed Spindle Bib Tap FI 50mm Extended with Aerated Outlet - Jumper Valve

TECHNICAL INFORMATION

Maximum Static Pressure	1200kPa
Working Pressure Range	50-500kPa
Maximum Working Temperature	95°C (Jumper Valve)

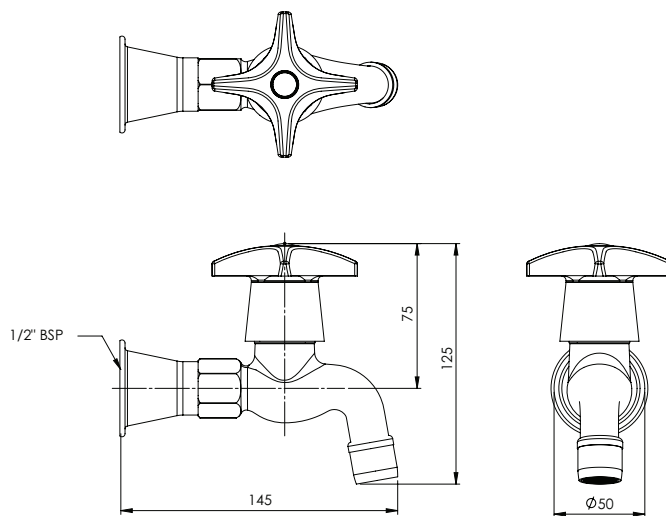

Enware products are to be installed in accordance with the Plumbing Code of Australia and AS/NZS3500. Reference should also be made to the Australasian Health facility Guidelines (AHFG), ABCB and Local Government regulations when considering the choice of, and the installation of these products.

Enware Australia advises:

1. Due to ongoing Research and Development, specifications may change without notice. 2. Component specifications may change on some export models. 3. Refer to warranty statement for warranty details - www.enware.com.au/warranty

Version 1.1__10Jan23