

Wall Mounted Sensor Tap - Hands-Free On / Off Demand Sensor with 250mm Spout

The Touch-Free Wall Mounted Sensor is a sensor operated, hands-free tap that is installed above sinks and basins. It operates by sensing a hand, placed within 5 cm of the sensor unit. It uses a beam of invisible Infrared light which, when reflected from hand back to the sensor, operates the unit.

ENM5072A-250

FEATURES

- To turn tap on, place hand in front of sensor for half a second
- To turn off tap, place hand in front of sensor again for half a second
- Valve stays open without hand remaining in the sensor range
- Maximum flow time 45 seconds*, reduces waste and overflow if accidentally activated
- Equipped with automatic hygiene flush function (1-10min/24hr) - enabled on request*
- Stainless steel sensor plate

* Longer flow times, hygiene flush function and other program settings are available at the time of ordering. Contact Enware for more information.

Product Codes

ENM5072A-250 With 250mm spout

OPTIONS

- With 205mm spout - ENM5072A-205
- Active Sense - ENM5071A-205, ENM5071A-250



Technical Information

Inlet Connection	15 mm (1/2") BSP
Recommended Working Pressure	100 - 500 kPa*
Flow Rate	4 star WELS rating (8 lpm laminar flow) supplied standard. 6 Star WELS rating (5 lpm aerated / laminar flow) available on request.
Maximum Temperature	70 °C *
Operating Voltage/ Max. Current / Power Consumption	24V DC / 1A / Less than 10W
Sensor Min / Max Ambient Temperature	Minimum: -5 °C, Maximum: 50 °C
Sensor Protection Rating	IP67 for the front panel and sensor lens. No IP rating behind panel.
Sensor Range	20 - 100mm
Flow Time	Place hand in sensor range to activate. Place hand in sensor range again to stop. Maximum of 45 seconds time out per activation.

*Enware products are to be installed in accordance with the Plumbing Code of Australia (PCA) and AS/NZS3500. Reference should also be made to the Australasian Health facility Guidelines (AHFG), ABCB and Local Government regulations when considering the choice of, and the installation of these products.

NOTE: Enware Australia advises: 1. Due to ongoing Research and Development, specifications may change without notice; 2. Component specifications may change on some export models.

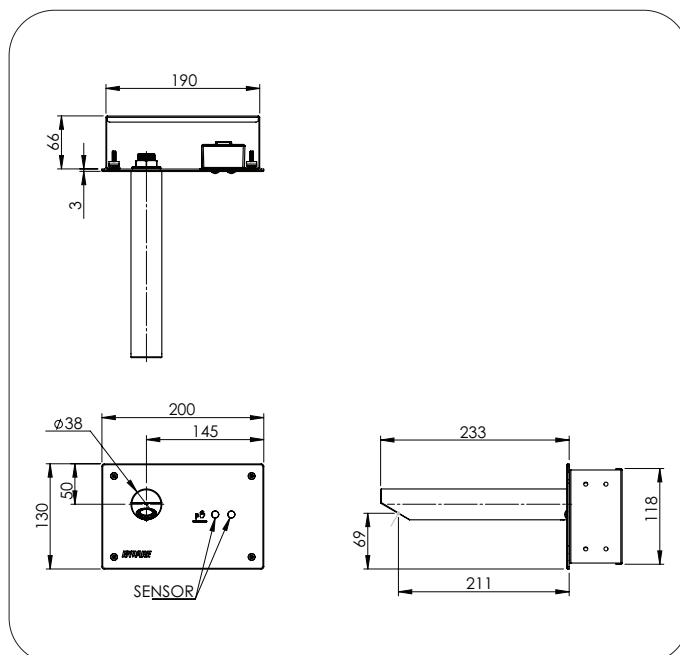

Version: Aug 21

Call 1300 369 273
www.enware.com.au

Enware Australia Pty Limited
9 Endeavour Rd Caringbah NSW 2229 Australia
Ph: 02 8536 4000 info@enware.com.au



Wall Mounted Sensor Tap - Hands-Free On / Off Demand Sensor with 250mm Spout

ENM5072A-250

COMPONENTS

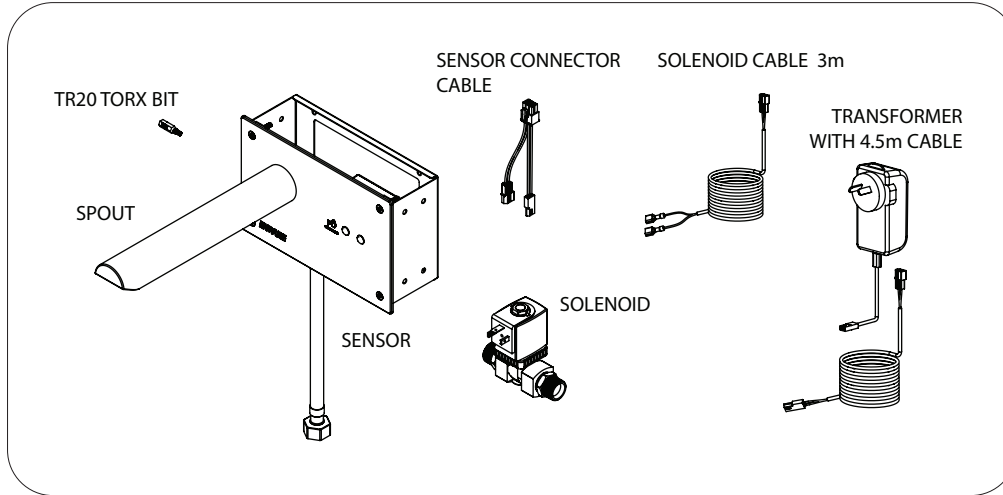

FLOW PATTERN

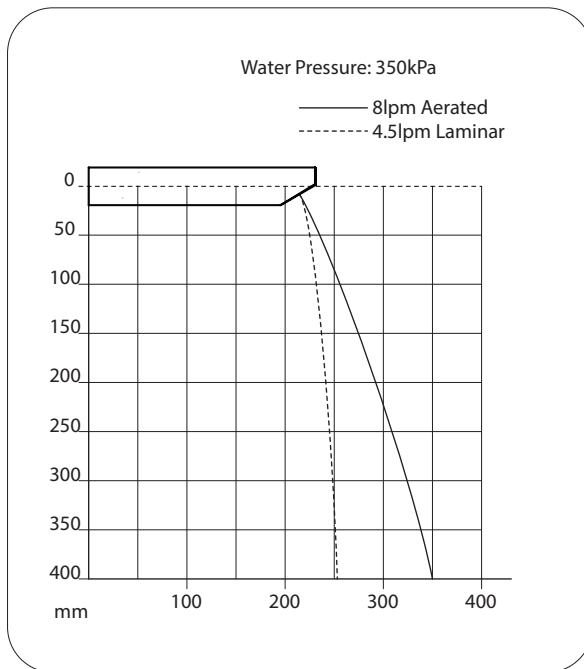

Version: Aug 21

Call 1300 369 273
www.enware.com.au

Enware Australia Pty Limited
9 Endeavour Rd Caringbah NSW 2229 Australia
Ph: 02 8536 4000 info@enware.com.au

