

Aquablend® eSQX™ Touch Free - On Demand Sensor Front of Wall Component with Custodian® Basin Outlet

ATWM-CNBSN

Aquablend® eSQX™ is Australia's first and most technically advanced touch-free thermostatic mixer solution. Designed to deliver touch-free pre-mixed warm water for enhanced infection control and cross-contamination prevention. The solution includes an infra-red sensor located above Custodian® basin outlet.

KEY FEATURES

- On Demand Sensor - place hand in front of sensor to turn on, valve stays open without hand remaining in the sensor range. Place hand in front of sensor again to turn off
- Low voltage 12V mains power supply
- Custodian® anti-ligature basin outlet
- Flush cycle stagnation management to reduce risk of bacterial growth, usage monitoring and other function settings are adjustable via Oras App and Bluetooth connectivity
- Effective reduction of Legionella risk
- Compatible with Smartflow Monitoring System for TMV monitoring and reporting
- Smart, durable easy-clean chrome surfaces
- IP67 rated connections
- Faceplate can be removed to access integral isolation/check valves, strainers and inspection ports
- Watermark Certified to AS4032.4
- Requires In-Wall Component ATM621



PRODUCT CODES

ATWM-CNBSN	eSQX Front of Wall Component On Demand Sensor - 12V Mains - Custodian Basin Outlet 8Lpm Aerator
------------	---

Order with:

ATM621	eSQX In Wall Component - 12V Mains
--------	------------------------------------

I00409_Version 1.0__FEB 23

Aquablend® eSQX™ Touch Free - On Demand Sensor Front of Wall Component with Custodian® Basin Outlet

TECHNICAL INFORMATION

Sensor Range	20-100mm (Factory default setting - adjustable)
Water Run Time	15 secs (+/-1) after activation (Factory default setting - adjustable)
Sensor Power Supply	12VDC

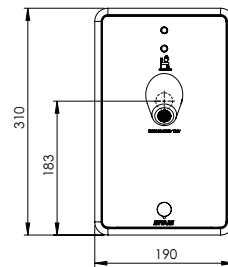
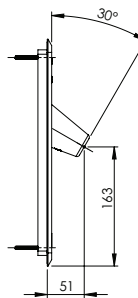
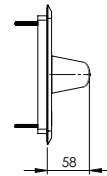

Water Flow Projection

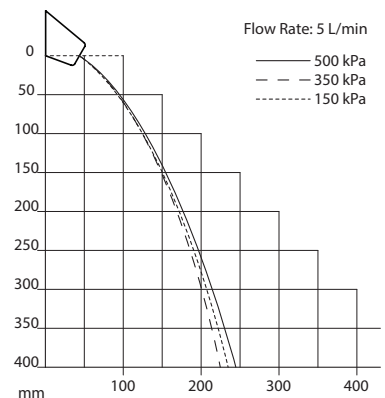
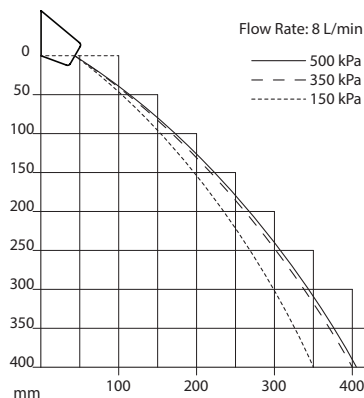

Enware products are to be installed in accordance with the Plumbing Code of Australia and AS/NZS3500. Reference should also be made to the Australasian Health facility Guidelines (AHFG), ABCB and Local Government regulations when considering the choice of, and the installation of these products.

Enware Australia advises:

1. Due to ongoing Research and Development, specifications may change without notice.
2. Component specifications may change on some export models.
3. Refer to warranty statement for warranty details - www.enware.com.au/warranty

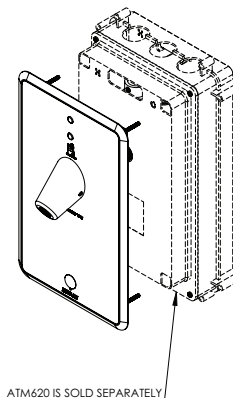

ATM420 IS SOLD SEPARATELY

I00409_Version 1.0__02Jun22

For the installation of the front of wall components, refer to Aquablend ESQX Installation and User Guide supplied with the In-Wall component.

For the installation of the spout component, see instructions below.

The Custodian® Basin Outlet - On Wall Mounted

Installation and Maintenance Instructions

CNBSN-FF



technical data

Inlet Connection	1/2" BSP (15mm) Female
Operating Working Pressure	50 - 500 kPa
Flow Rate	8 l/m
Maximum Water Temperature	70 °C

Enware products are to be installed in accordance with the Plumbing Code of Australia (PCA) and AS/NZS3500. Installations not complying with PCA and AS/NZS 3500 may void the product and performance warranty provisions.

Reference should also be made to the Australasian Health Facility Guidelines (AHFG), ABCB and Local Government regulations when considering the choice of, and the installation of these products.

NOTE: Enware Australia advises:

1. Due to ongoing research and development, specifications may change without notice.
2. Component specifications may change on some export models.

dimensions

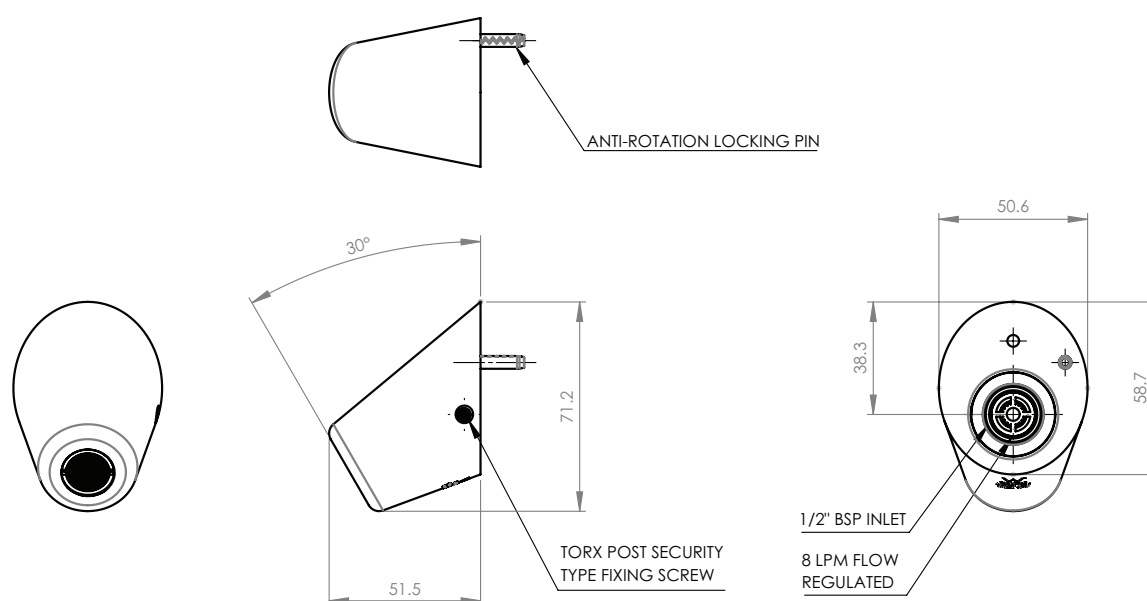

All measurements are in millimetres.

components

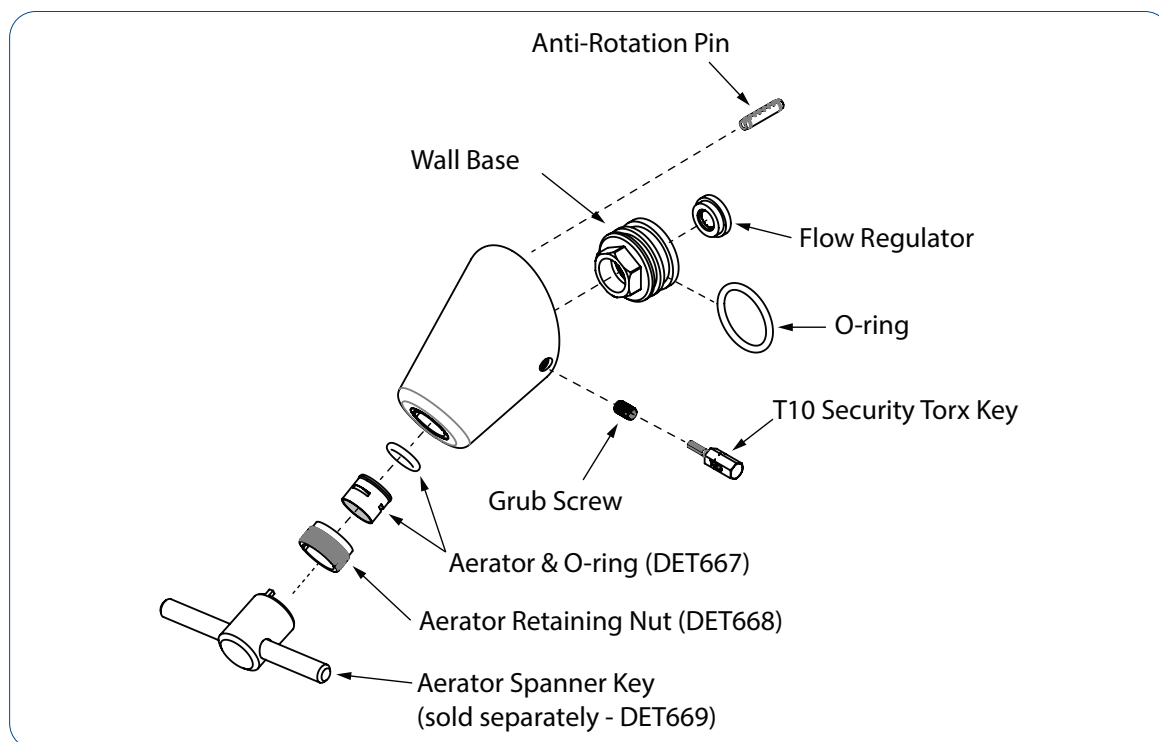

spare parts

Name		Part Code
Aerator & O-ring		DET667
Aerator Retaining Nut		DET668
Aerator Spanner Key		DET669
Wall Base		894067
Flow Regulator		671445
O-Ring BS119		672352
Anti-Rotation Pin 4mm x 20mm		672384
Grub Screw M5 x 8 Torx Post SS304		671880
Torx Key Post T-10 Driver Bit		671184

installation

1. Determine position of the product to be installed.
Consider the flow pattern of the water from the outlet to determine the height of the spout.

BASIN OUTLET FLOW PROJECTION

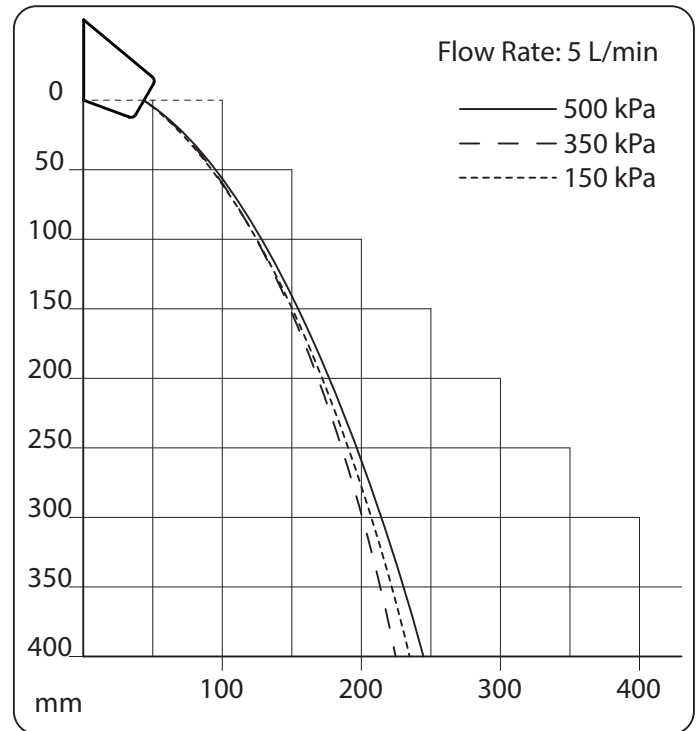
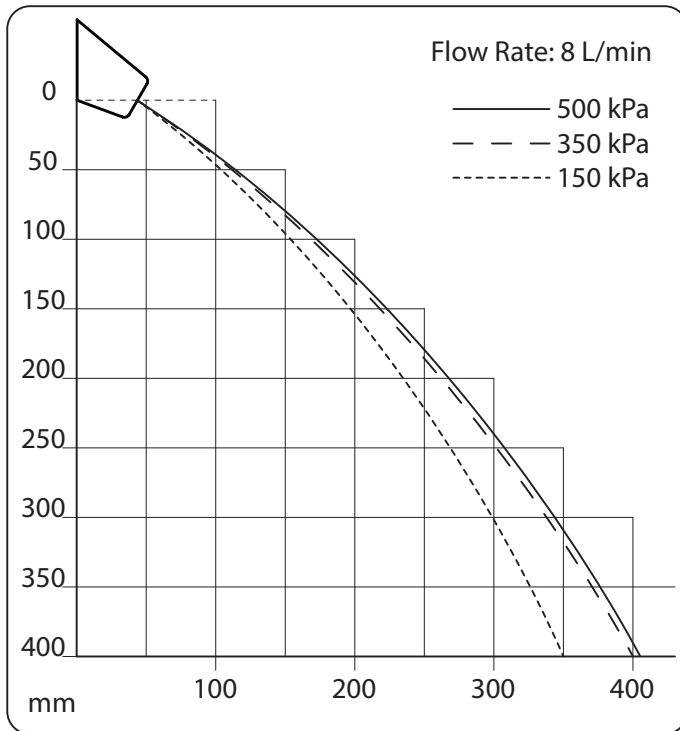

IMAGE 01

2. Prepare the 1/2" BSP thread on wall, allowing 10mm of thread to protrude from the face plate. SEE IMAGE 02

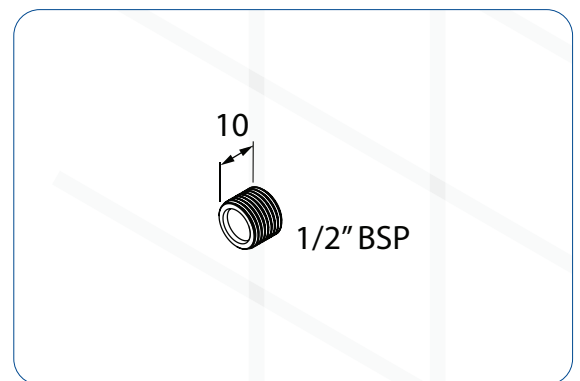

IMAGE 02

3. Flush the water supply line. Ensure there are no debris or contaminants.

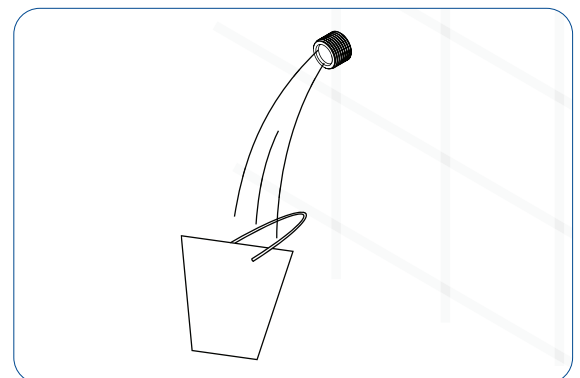

IMAGE 03

4. To disassemble wall base from spout, first loosen the grub screw on the side of spout, using the T10 Torx key supplied. Take the grub screw out and keep at hand.

Loosely screw a 1/2" thread fitting onto the female thread of wall base located on the back of spout, and pull out the wall base from the spout assembly.

5. Apply thread sealant to the thread on wall.
6. Screw wall base onto the thread, all the way until the wall base is tight against the face plate. Use a spanner on the hex of the wall base to tighten. SEE IMAGE 04
7. Fit anti-rotation pin into the centre hole on the back of spout. SEE IMAGE 05
8. Fit spout onto the wall base.

If required, apply anti-pick silicone or silicone sealant of appropriate grade, around the edges on the contact surface.

Push the spout all the way so that it is tight against the face plate.

Make sure the anti-rotation pin locates correctly and that there are no gaps between the wall and the spout.

9. Secure the spout in position with the grub screw. Use T10 Torx key to tighten the grub screw with a small spanner. Do not over-tighten. SEE IMAGE 06
10. Turn on water supply and test operation. Refer to Troubleshooting if there is any problem.

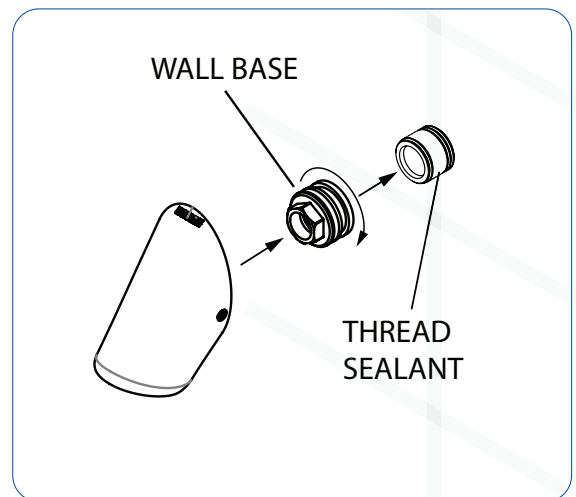

IMAGE 04

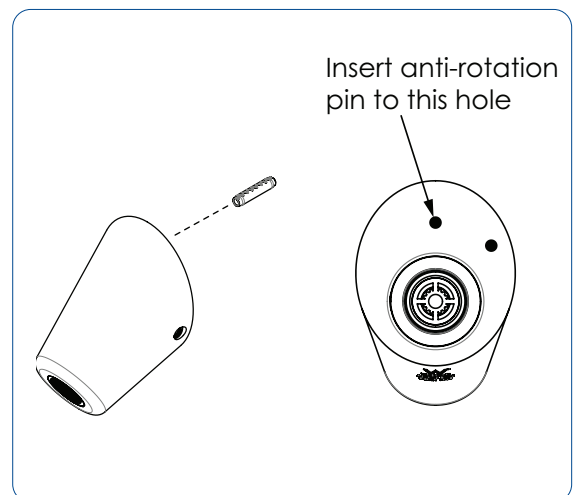

IMAGE 05

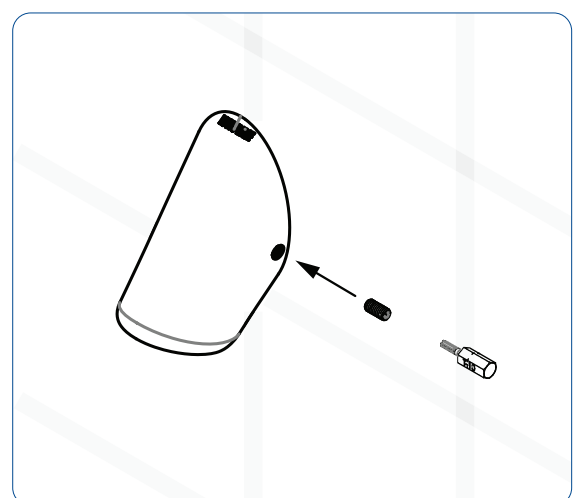
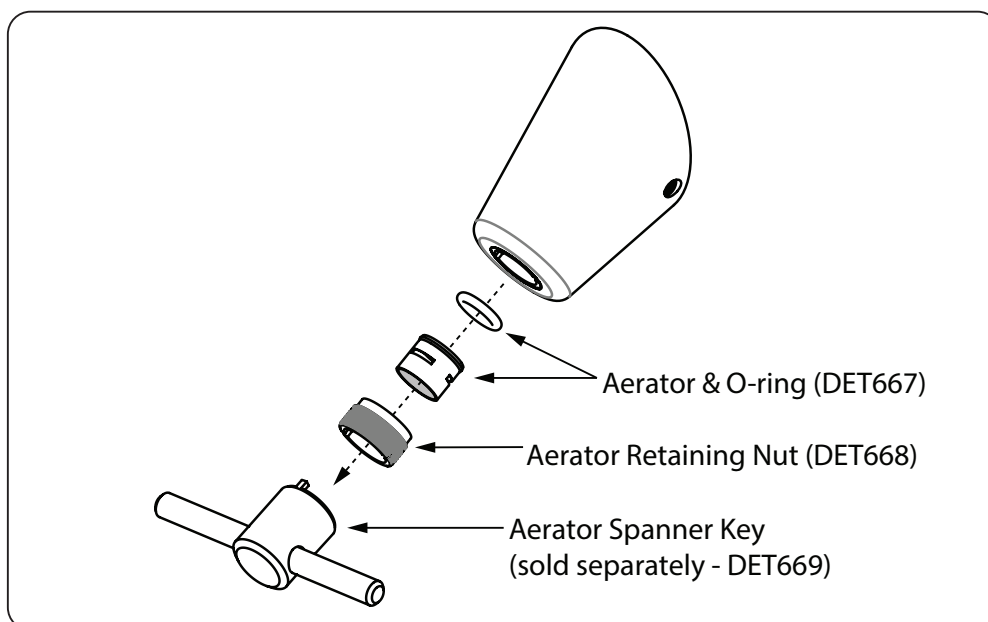

IMAGE 06

troubleshooting

FAULT / SYMPTOM	CAUSE	RECTIFICATION
1. Poor water flow	* Debris in line	* Dismantle spout aerator and clean / reverse rinse aerator. * Dismantle flow control and clean. Replace if necessary.
2. Leaking from wall base	O-ring is damaged or missing	Check and clean or replace O-ring on the wall base

access to aerator



cleaning

Enware products should be cleaned with a soft damp cloth using only mild liquid detergent or soap and water. Do not use cleaning agents containing a corrosive acid, scouring agent or solvent chemicals. Do not use cream cleaners, as they are abrasive. Use of unsuitable cleaning agents may damage the surface. Any damage caused in this way will not be covered by warranty.

ADDRESS: 9 Endeavour Rd Caringbah NSW 2229 Australia

POSTAL ADDRESS: P.O. Box 2545, Taren Point NSW 2229 Australia

PHONE: +61 2 8556 4000

1300 369 273 (AUS) WWW.ENWARE.COM.AU INFO@ENWARE.COM.AU

